

Floor Plan

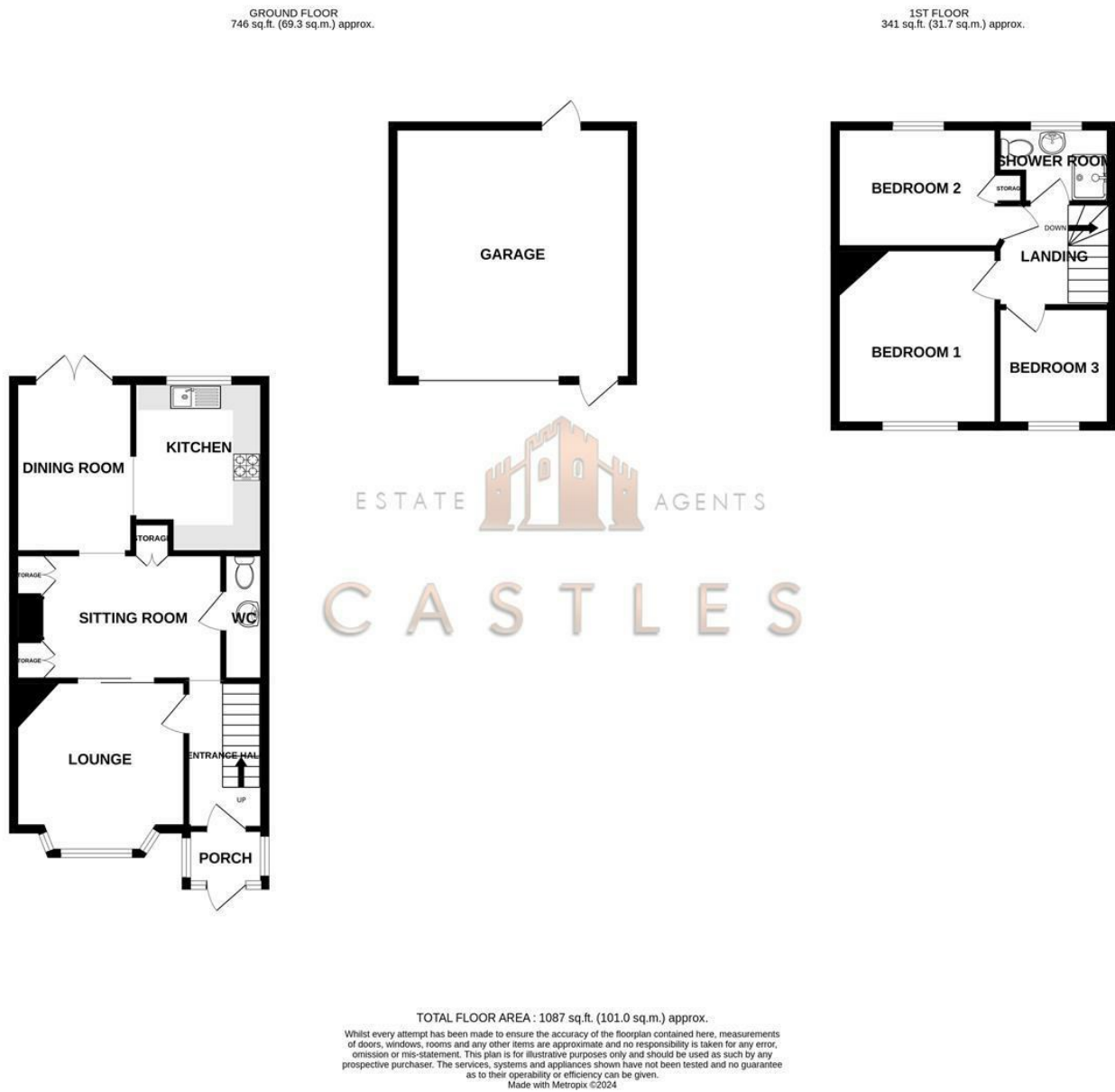

11 Marina Grove
Portchester, PO16 9HE



- THREE BEDROOMS
- DOUBLE GARAGE TO REAR
- CLOSE TO LOCAL SHOPS
- OFF ROAD PARKING
- OPEN PLAN KITCHEN DINER
- SHORT WALK TO WATERFRONT

LOUNGE
11'1" x 11'1" (3.4 x 3.4)

SITTING ROOM
12'9" x 8'2" (3.9 x 2.5)

DINING ROOM
6'6" x 10'9" (2.0 x 3.3)

KITCHEN
7'10" x 11'1" (2.4 x 3.4)

W/C
2'7" x 6'10" (0.8 x 2.1)

SHOWER ROOM
7'2" x 4'11" (2.2 x 1.5)

BEDROOM 1
9'6" x 11'1" (2.9 x 3.4)

BEDROOM 2
10'5" x 7'10" (3.2 x 2.4)

BEDROOM 3
6'6" x 7'6" (2.0 x 2.3)

GARAGE
15'5" x 16'4" (4.7 x 5.0)

Financial Services
If you are looking to get a comparison on your mortgage deal then do let us know as we can put you in touch with some independent mortgage advisors that would be happy to help. It is always worth a last minute comparison before you purchase a property as the current deals can change weekly.

Solicitors
If you are looking for a solicitor to handle the conveyancing process then do let us know as we can point you in the

direction of some local, well recommended companies that would be happy to help and provide you with a quote.

Anti Money Laundering
Castles Estate Agents have a legal obligation to complete anti-money laundering checks via a portal called Credas. Please note the Credas AML check includes taking a copy of identification for each purchaser, a proof of address and proof of name document is required. Please note we cannot agree a transaction without the Credas AML check being completed.

